

# SURVEYING

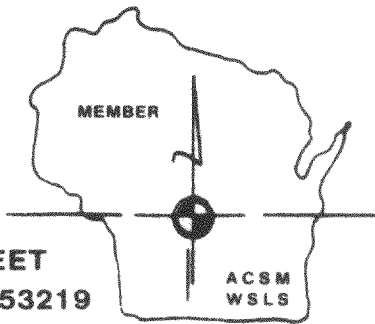

# ASSOCIATES, INC.

2819 SOUTH 43rd STREET  
MILWAUKEE, WISCONSIN 53219

FREDERICK W. SHIBILSKI RLS  
(414) 321-5851

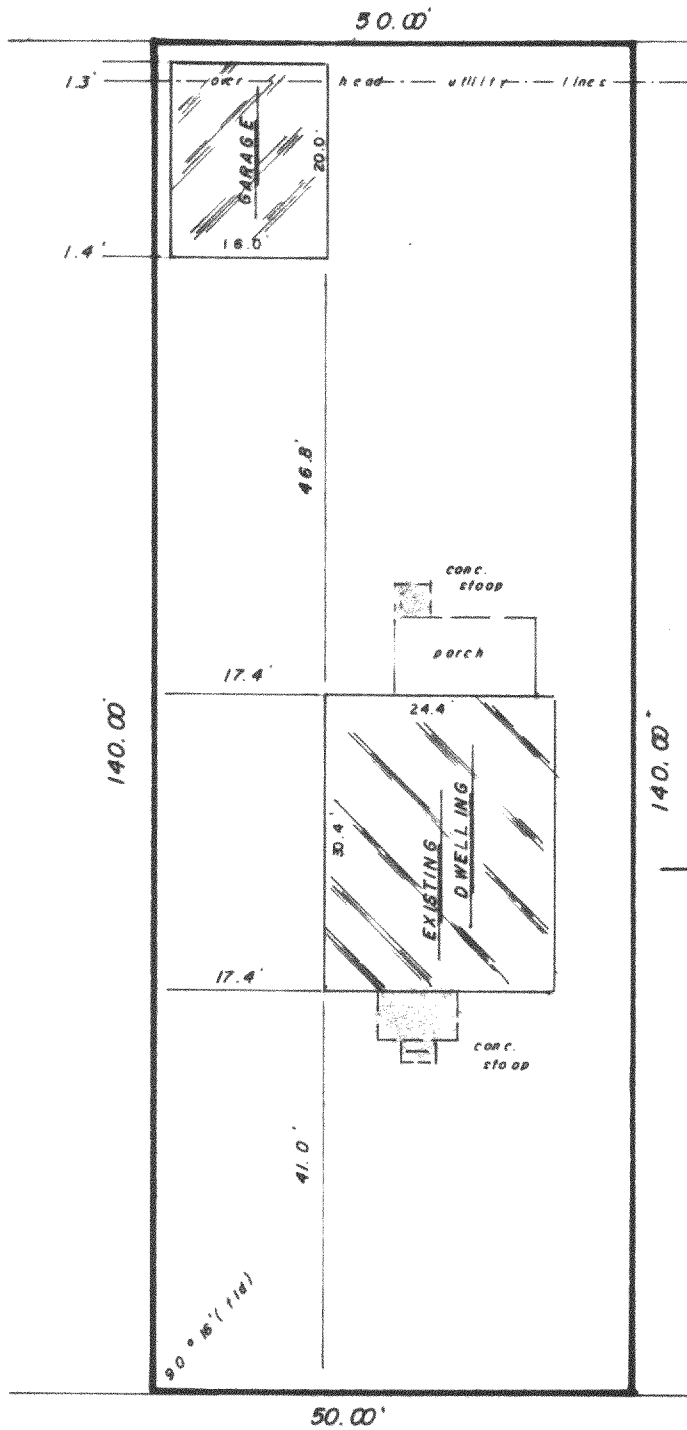

PLAT OF SURVEY  
-of-

LOT 18, BLOCK 8, MIRAMAR SUBDIVISION (on  
Potter Lake), being a part of Section 10  
and 11, Town 4 North, Range 18 East, in the  
Town of East Troy, Walworth County, Wis-  
consin.

Survey location: 1029 Maple Street  
Buyer: David Brotzel

SCALE 1" = 20'

## MAPLE ST.

40' WIDE

Surveyed for: S-F MORT. CORP.

"I hereby certify that I have surveyed the above described property and that the above map is a true representation thereof and shows the size and location of the property, its exterior boundaries, the location of all visible structures and dimensions of all principal buildings thereon, boundary fences, apparent easements, roadways and encroachments, if any.

"This survey is made for the use of the present owners of the property, and also those who purchase, mortgage, or guarantee the title thereto within one year from date hereof."

MONUMENTATION BY WRITTEN AGREEMENT WITH THE ABOVE NAMED CLIENT.

(HAS BEEN) BEEN WAIVED IN ACCORDANCE WITH A-E 5.01 (1) (b) OF THE WISCONSIN ADMINISTRATIVE CODE



*Frederick W. Shibilski*  
WISCONSIN REGISTERED LAND SURVEYOR

MAY 25, 1984  
DATE

bjw:jm  
FIELD WORK BY

mdn  
DRAWN BY

4616  
JOB NUMBER

PMR-105B

418-450 ✓